

**RESCOM**  
MODULAR™



- Full Duplex
- Intrinsically Safe
- Personal Volume Control
- 3 Mile Range Per User
- Connects up to 10 Users
- Compliant & Certified by Major Industry Standards
- Low Battery Indicator for Entire Team
- Immune to RF Interference
- 5 Year Limited Warranty



*Confined Space Communication Leader  
Since 1985*

## HEADSETS



**DQ70-108**  
**Dual-Sided Heavy Duty Headset with Boom Mic**  
Rear headband mount with Noise-Attenuating earcup and Noise-Cancelling Mic



**DQ70-106**  
**Dual-Sided Heavy Duty Headset with Throat Mic**  
Rear headband mount with Noise Attenuating earcup and Noise-Rejecting Mic



**198915**  
**Dual-Sided Watertight Headset with Throat Mic**  
Mesh mounted lightweight headsets with Noise-Rejecting Mic



**198914**  
**Single-Sided Watertight Headset with Throat Mic**  
Mesh mounted lightweight headsets with Noise-Rejecting Mic



**198913**  
**Single-Sided Lightweight Headset with Throat Mic**  
Mesh mounted lightweight headsets with Noise-Rejecting Mic

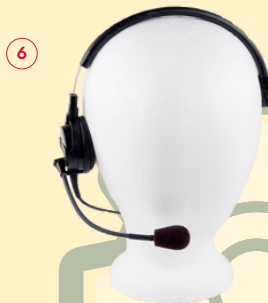

**198902-SE05**  
**Single-Sided Lightweight Headset with Boom Mic**  
Light Headband with Noise-Cancelling Mic

## INTERFACES & JUNCTION BOX



**DMI-S**  
**Master Interface Box**  
Centralized battery, On/Off switch, volume control and an industrial grade pouch to mount on belt/harness



**DSI-S**  
**Slave Interface Box**  
With volume control and an industrial grade pouch to mount on belt/harness

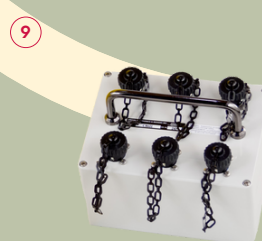

**C86H or C88H**  
**6 or 8 Port Junction Box**  
Watertight connectors in a sturdy ABS box



**V-MIC™**  
**Victim Locator Mic**  
Super sensitive Mic used for victim location during a rescue



**RSP-05**  
**Responder 5\***  
Water resistant speaker box with a PTT Mic allows local monitoring, eliminating the need for headsets



**DSI-AC/S16**  
**Acoustic Coupler**  
An Inter-Operability Interface that allows an isolated interconnection between two intrinsically safe systems

# ACCESSORIES

13



**SCR2N Series  
Combined Safety/  
Communication Rope™**  
Use as a primary or  
secondary rescue line. Can  
be submerged 35ft in water

14



**EC2MMD02 Series  
Communication Cable**  
A rugged DuraCORE™ cable  
with a SEDFLEX™ jacket  
ensuring flexibility in harsh  
environments

15



**C32D  
Rope/Cable Coupler**  
Used to connect two  
Rescom communication  
ropes (13) or cables (14)  
together

16



**C11  
Bulkhead Pass-through**  
Allows connection through  
steel vessel or walls of  
thickness up to 1". Ideal for  
aircraft fuel cell installation

17



**C09  
T-connector**  
Allows "Daisy Chain" of  
cable or rope connections,  
Can be attached directly to  
DMI or DSI or Junction Box

18



**040901 Series  
Push-To-Mute (PTM) or  
Push-To-Talk (PTT) Switch**  
Ideal for Supervisors. Can be  
Locked On or used as a  
momentary action

19



**RCC-01 or RCC-02  
Portable Cable Reel**  
Built-in junction box for  
continuous communication  
with pneumatic tires for  
uneven surfaces

20



**330002 - S or M size  
Rescom Rope bag**  
(S:100ft and M:300ft rope)  
Sturdy fabric with a clear  
pouch for rope logs, carry  
handle and shoulder strap.

## TYPICAL CONNECTION DIAGRAM

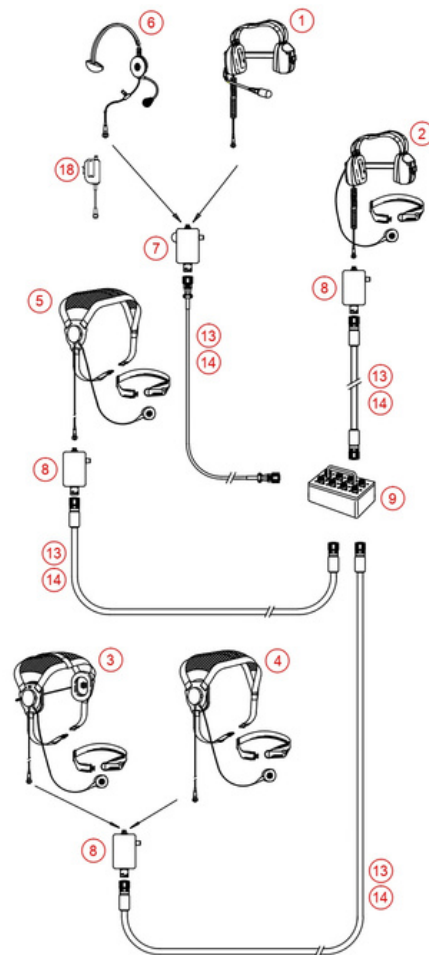

**BATTERY LIFE  
FOR 3 AA  
BATTERIES:**

3 Headsets= 108-138 hours  
5 Headsets= 64-82 hours  
7 Headsets= 46-58 hours  
10 Headsets= 27-34 hours



# APPLICATIONS

Public Utilities  
Chemical Processing Plants  
Chemical Distillation Plants  
Telecommunications Providers  
Refineries  
Water Reclamation  
Breweries  
Environmental Services  
Manufacturing  
Nuclear  
Fire Departments / Search & Rescue  
Training Facilities  
Agricultural  
Shipping  
Mining  
Aircraft  
Maintenance

*Tunnels, water, vaults, boilers, furnaces*  
*Storage vessels, pipes, process reactors, tanks, vats*  
*Oxidation tanks, chemical vats, tanks*  
*Underground tunnels, crane*  
*Towers, tanks, pipelines, boilers, furnaces*  
*Wastewater management, tunnels, pipes, sewers, pits, tanks, wells*  
*Vats and fermentation vessels*  
*Hazmat, sewers, tunnels, manholes, ditches, septic & holding tanks*  
*Smokestacks, tunnels, holding tanks*  
*Reactor vaults, inspection*  
*High angle, extrication, confined space rescue*  
*Rescue, high angle rappelling*  
*Silos, mills, grain elevators*  
*Ship's holds, compartments*  
*Rescue, open pits*  
*Wing fuel tanks, aircraft sections, riveting de-icing*  
*Sandblasting, water blasting, welding, clean-up*



**All Rescom Modular kits include a carrying case. Kits may be expanded to accommodate up to 10 users per system.**

## Rescom Kits - DuraCORE™ Communication Cable

### 2 MAN Cable Kits

RK2MC-030 (1) 100' Communication Cable, (1) DMI, (1) DSI, (1) 198902, (1) 198913, Medium Equipment Case  
RK2MC-091 (1) 300' Communication Cable, (1) DMI, (1) DSI, (1) 198902, (1) 198913, Medium Equipment Case

### 3 MAN Cable Kits

RK3MC-030 (2) 100' Communication Cable, (1) 50' Communication Cable, (1) DMI, (2) DSI, (1) 198902, (2) 198913, 6 Port Junction Box, Medium Equipment Case  
RK3MC-091 (2) 300' Communication Cable, (1) 50' Communication Cable, (1) DMI, (2) DSI, (1) 198902, (2) 198913, 6 Port Junction Box, Medium Equipment Case

### 5 MAN Cable Kits

RK5MC-030 (4) 100' Communication Cable, (1) 50' Communication Cable, (2) DMI, (3) DSI, (1) 198902, (4) 198913, 6 Port Junction Box, Medium Equipment Case  
RK5MC-091 (4) 300' Communication Cable, (1) 50' Communication Cable, (2) DMI, (3) DSI, (1) 198902, (4) 198913, 6 Port Junction Box, Medium Equipment Case

### 7 MAN Cable Kits

RK7MC-030 (6) 100' Communication Cable, (1) 50' Communication Cable, (2) DMI, (5) DSI, (1) 198902, (6) 198913, 8 Port Junction Box, Large Equipment Case  
RK7MC-091 (6) 300' Communication Cable, (1) 50' Communication Cable, (2) DMI, (5) DSI, (1) 198902, (6) 198913, 8 Port Junction Box, Large Equipment Case



### APPROVED

Tested for Intrinsic Safety in Methane-Air Mixtures Only (Communication Cable System)



### APPROVED

CSA as per C22.2 No.157-92 in Canada, & U.L. as per #913 in USA.

- Class I, Div. 1 Groups A,B,C,D
- Class II, Div. 1 Groups E,F,G
- Class III, Div.1, Gaseous Mines

## Rescom Kits - Rope and DuraCORE™ cable

### 2 MAN Rope Kits

RK2MR-030 (1) 100' Combined Safety/Communications Rope, (1) DMI, (1) DSI, (1) 198902, (1) 198913, Small Rope Bag, Medium Equipment Case  
RK2MR-091 (1) 300' Combined Safety/Communications Rope, (1) DMI, (1) DSI, (1) 198902, (1) 198913, Medium Rope Bag, Medium Equipment Case

### 3 MAN Rope Kits

RK3MR-030 (2) 100' Combined Safety/Communications Rope, (1) 50' Communication Cable, (1) DMI, (2) DSI, (1) 198902, (2) 198913, 6 Port Junction Box, (2) Small Rope Bag, Medium Equipment Case  
RK3MR-091 (2) 300' Combined Safety/Communications Rope (1) 50' Communication Cable, (1) DMI, (2) DSI, (1) 198902, (2) 198913, 6 Port Junction Box, (2) Medium Rope Bag, Medium Equipment Case

### 5 MAN Rope Kits

RK5MR-030 (4) 100' Combined Safety/Communications Rope, (1) 50' Communication Cable, (2) DMI, (3) DSI, (1) 198902, (4) 198913, 6 Port Junction Box, (4) Small Rope Bags, Medium Equipment Case  
RK5MR-091 (4) 300' Combined Safety/Communications Rope, (1) 50' Communication Cable, (2) DMI, (3) DSI, (1) 198902, (4) 198913, 6 Port Junction Box, (4) Medium Rope Bags, Medium Equipment Case

### 7 MAN Rope Kits

RK7MR-030 (6) 100' Combined Safety/Communications Rope, (1) 50' Communication Cable, (2) DMI, (5) DSI, (1) 198902, (6) 198913, 8 Port Junction Box, (6) Small Rope Bags, Large Equipment Case  
RK7MR-091 (6) 300' Combined Safety/Communications Rope, (1) 50' Communication Cable, (2) DMI, (5) DSI, (1) 198902, (6) 198913, 8 Port Junction Box, (6) Medium Rope Bags, Large Equipment Case



### COMPLIANT

Rescom Modular system meets all OSHA safety standards for confined space entry



### APPROVED

Combined Safety/ Communication Rope™ is compliant under Class - 7216 82