

RESCOM
MODULAR™



- Full Duplex
- Intrinsically Safe
- Personal Volume Control
- 3 Mile Range Per User
- Connects up to 10 Users
- Compliant & Certified by Major Industry Standards
- Low Battery Indicator for Entire Team
- Immune to RF Interference
- 5 Year Limited Warranty



*Confined Space Communication Leader
Since 1985*

HEADSETS



DQ70-106
Dual-Sided Heavy Duty Headset with Boom Mic
Rear headband mount with Noise-Attenuating earcup and Noise-Cancelling Mic



DQ70-108
Dual-Sided Heavy Duty Headset with Throat Mic
Rear headband mount with Noise Attenuating earcup and Noise-Rejecting Mic



198915
Dual-Sided Watertight Headset with Throat Mic
Mesh mounted lightweight headsets with Noise-Rejecting Mic



198914
Single-Sided Watertight Headset with Throat Mic
Mesh mounted lightweight headsets with Noise-Rejecting Mic



198913
Single-Sided Lightweight Headset with Throat Mic
Mesh mounted lightweight headsets with Noise-Rejecting Mic

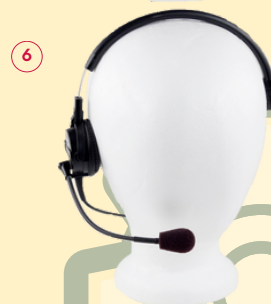

198902-SE05
Single-Sided Lightweight Headset with Boom Mic
Light Headband with Noise-Cancelling Mic

INTERFACES & JUNCTION BOX



DMI-S
Master Interface Box
Centralized battery, On/Off switch, volume control and an industrial grade pouch to mount on belt/harness



DSI-S
Slave Interface Box
With volume control and an industrial grade pouch to mount on belt/harness



C86H or C88H
6 or 8 Port Junction Box
Watertight connectors in a sturdy ABS box



V-MIC™
Victim Locator Mic
Super sensitive Mic used for victim location during a rescue



RSP-05
Responder 5*
Water resistant speaker box with a PTT Mic allows local monitoring, eliminating the need for headsets



DSI-AC/S16
Acoustic Coupler
An Inter-Operability Interface that allows an isolated interconnection between two intrinsically safe systems

ACCESSORIES

13



**SCR2N Series
Combined Safety/
Communication Rope™**
Use as a primary or
secondary rescue line. Can
be submerged 35ft in water

14



**EC2MMD02 Series
Communication Cable**
A rugged DuraCORE™ cable
with a SEDFLEX™ jacket
ensuring flexibility in harsh
environments

15



**C32D
Rope/Cable Coupler**
Used to connect two
Rescom communication
ropes (13) or cables (14)
together

16



**C11
Bulkhead Pass-through**
Allows connection through
steel vessel or walls of
thickness up to 1". Ideal for
aircraft fuel cell installation

17



**C09
T-connector**
Allows "Daisy Chain" of
cable or rope connections,
Can be attached directly to
DMI or DSI or Junction Box

18



**040901 Series
Push-To-Mute (PTM) or
Push-To-Talk (PTT) Switch**
Ideal for Supervisors. Can be
Locked On or used as a
momentary action

19



**RCC-01 or RCC-02
Portable Cable Reel**
Built-in junction box for
continuous communication
with pneumatic tires for
uneven surfaces

20



**330002 - S or M size
Rescom Rope bag**
(S:100ft and M:300ft rope)
Sturdy fabric with a clear
pouch for rope logs, carry
handle and shoulder strap.

TYPICAL CONNECTION DIAGRAM

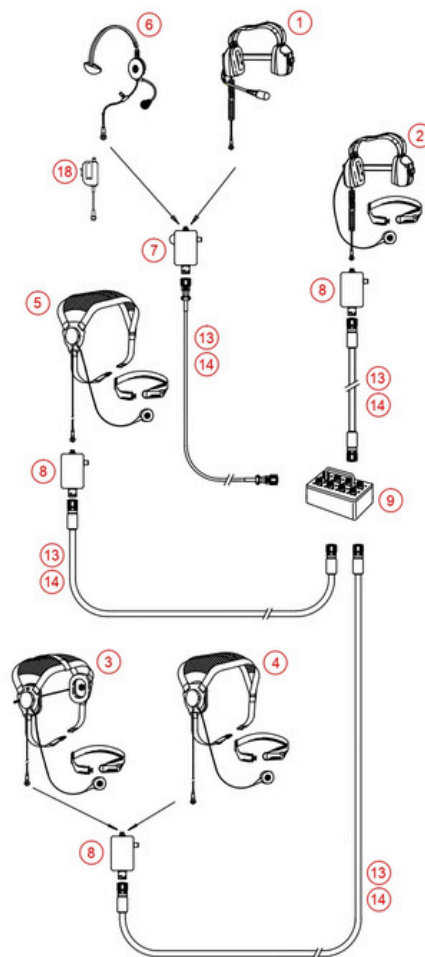

**BATTERY LIFE
FOR 3 AA
BATTERIES:**

3 Headsets= 108-138 hours
5 Headsets= 64-82 hours
7 Headsets= 46-58 hours
10 Headsets= 27-34 hours

APPLICATIONS

Public Utilities
Chemical Processing Plants
Chemical Distillation Plants
Telecommunications Providers
Refineries
Water Reclamation
Breweries
Environmental Services
Manufacturing
Nuclear
Fire Departments / Search & Rescue
Training Facilities
Agricultural
Shipping
Mining
Aircraft
Maintenance

Tunnels, water, vaults, boilers, furnaces
Storage vessels, pipes, process reactors, tanks, vats
Oxidation tanks, chemical vats, tanks
Underground tunnels, crane
Towers, tanks, pipelines, boilers, furnaces
Wastewater management, tunnels, pipes, sewers, pits, tanks, wells
Vats and fermentation vessels
Hazmat, sewers, tunnels, manholes, ditches, septic & holding tanks
Smokestacks, tunnels, holding tanks
Reactor vaults, inspection
High angle, extrication, confined space rescue
Rescue, high angle rappelling
Silos, mills, grain elevators
Ship's holds, compartments
Rescue, open pits
Wing fuel tanks, aircraft sections, riveting de-icing
Sandblasting, water blasting, welding, clean-up



All Rescom Modular kits include a carrying case. Kits may be expanded to accommodate up to 10 users per system.

Rescom Kits - DuraCORE™ Communication Cable

2 MAN Cable Kits

RK2MC-030 (1) 100' Communication Cable, (1) DMI, (1) DSI, (1) 198902, (1) 198913, Medium Equipment Case
RK2MC-091 (1) 300' Communication Cable, (1) DMI, (1) DSI, (1) 198902, (1) 198913, Medium Equipment Case

3 MAN Cable Kits

RK3MC-030 (2) 100' Communication Cable, (1) 50' Communication Cable, (1) DMI, (2) DSI, (1) 198902, (2) 198913, 6 Port Junction Box, Medium Equipment Case
RK3MC-091 (2) 300' Communication Cable, (1) 50' Communication Cable, (1) DMI, (2) DSI, (1) 198902, (2) 198913, 6 Port Junction Box, Medium Equipment Case

5 MAN Cable Kits

RK5MC-030 (4) 100' Communication Cable, (1) 50' Communication Cable, (2) DMI, (3) DSI, (1) 198902, (4) 198913, 6 Port Junction Box, Medium Equipment Case
RK5MC-091 (4) 300' Communication Cable, (1) 50' Communication Cable, (2) DMI, (3) DSI, (1) 198902, (4) 198913, 6 Port Junction Box, Medium Equipment Case

7 MAN Cable Kits

RK7MC-030 (6) 100' Communication Cable, (1) 50' Communication Cable, (2) DMI, (5) DSI, (1) 198902, (6) 198913, 8 Port Junction Box, Large Equipment Case
RK7MC-091 (6) 300' Communication Cable, (1) 50' Communication Cable, (2) DMI, (5) DSI, (1) 198902, (6) 198913, 8 Port Junction Box, Large Equipment Case



APPROVED

Tested for Intrinsic Safety in Methane-Air Mixtures Only (Communication Cable System)



APPROVED

CSA as per C22.2 No.157-92 in Canada, & U.L. as per #913 in USA.

- Class I, Div. 1 Groups A,B,C,D
- Class II, Div. 1 Groups E,F,G
- Class III, Div.1, Gaseous Mines

Rescom Kits - Rope and DuraCORE™ cable

2 MAN Rope Kits

RK2MR-030 (1) 100' Combined Safety/Communications Rope, (1) DMI, (1) DSI, (1) 198902, (1) 198913, Small Rope Bag, Medium Equipment Case
RK2MR-091 (1) 300' Combined Safety/Communications Rope, (1) DMI, (1) DSI, (1) 198902, (1) 198913, Medium Rope Bag, Medium Equipment Case

3 MAN Rope Kits

RK3MR-030 (2) 100' Combined Safety/Communications Rope, (1) 50' Communication Cable, (1) DMI, (2) DSI, (1) 198902, (2) 198913, 6 Port Junction Box, (2) Small Rope Bag, Medium Equipment Case
RK3MR-091 (2) 300' Combined Safety/Communications Rope, (1) 50' Communication Cable, (1) DMI, (2) DSI, (1) 198902, (2) 198913, 6 Port Junction Box, (2) Medium Rope Bag, Medium Equipment Case

5 MAN Rope Kits

RK5MR-030 (4) 100' Combined Safety/Communications Rope, (1) 50' Communication Cable, (2) DMI, (3) DSI, (1) 198902, (4) 198913, 6 Port Junction Box, (4) Small Rope Bags, Medium Equipment Case
RK5MR-091 (4) 300' Combined Safety/Communications Rope, (1) 50' Communication Cable, (2) DMI, (3) DSI, (1) 198902, (4) 198913, 6 Port Junction Box, (4) Medium Rope Bags, Medium Equipment Case

7 MAN Rope Kits

RK7MR-030 (6) 100' Combined Safety/Communications Rope, (1) 50' Communication Cable, (2) DMI, (5) DSI, (1) 198902, (6) 198913, 8 Port Junction Box, (6) Small Rope Bags, Large Equipment Case
RK7MR-091 (6) 300' Combined Safety/Communications Rope, (1) 50' Communication Cable, (2) DMI, (5) DSI, (1) 198902, (6) 198913, 8 Port Junction Box, (6) Medium Rope Bags, Large Equipment Case



COMPLIANT

Rescom Modular system meets all OSHA safety standards for confined space entry



APPROVED

Combined Safety/ Communication Rope™ is compliant under Class - 7216 82